



## 10 Stirrup Field

Golborne, Warrington, WA3 3AL

**£795 PCM**



Sapphire Homes are delighted to be in a position to offer For Rent this well presented 2 bedroom mid mews style house which is situated in the centre of Golborne with easy access to the M6 and A580 and all local amenities. The property comprises of a entrance / vestibule, spacious lounge including modern fitted kitchen/diner, WC, 2 double bedrooms and a family bathroom / master ensuite with modern three piece suite in white with shower over bath. The property is warmed by gas central heating and also benefits from Double Glazing and newly refreshed neutral décor throughout. The property is perfect for professional or couple and early internal viewing is highly recommended.



GROUND FLOOR

Entrance / Porch

Downstairs WC

Lounge

Kitchen / Diner

FIRST FLOOR

Master Bedroom

Bedroom 2

Bathroom

EXTERNAL

Area Map



Floor Plans

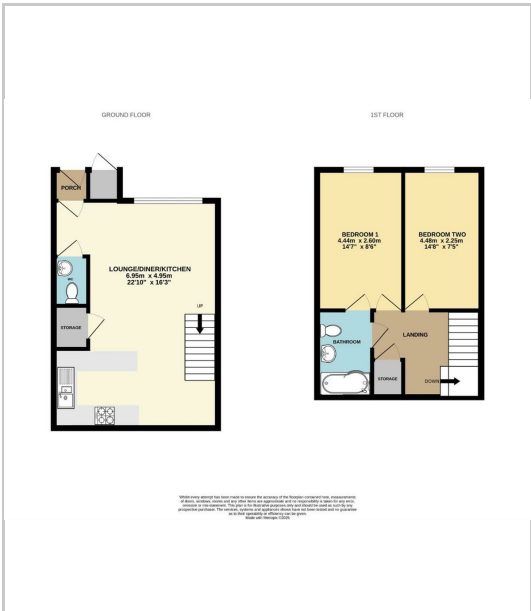

Energy Efficiency Graph

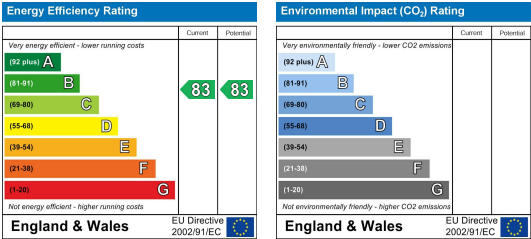

These particulars, whilst believed to be accurate are set out as a general outline only for guidance and do not constitute any part of an offer or contract. Intending purchasers should not rely on the representation of fact, but must satisfy themselves by inspection or otherwise as to their accuracy. No person in this firms employment has the authority to make or give any representation or warranty in relation to the property.

