



Lacock Gardens,
Maidstone ME15 6GT
Offers In The Region Of £285,000

COLES
TOWN & COUNTRY
VALUERS • LETTINGS & ESTATE AGENTS

Nestled in the charming area of Lacock Gardens, Maidstone, this delightful house offers a perfect blend of modern living and comfort.

Inside, you will find a well-appointed reception room that provides a welcoming space for relaxation and entertaining. The house features two spacious bedrooms, ideal for a small family or as a guest room. The bathroom is thoughtfully designed, ensuring convenience and comfort for all residents.

One of the standout features of this property is the allocated parking space, a valuable asset in this desirable location. Whether you are an investor looking to expand your portfolio or a first-time buyer seeking a lovely home, this property presents an excellent opportunity.

With its modern amenities and appealing layout, this house in Lacock Gardens is sure to attract interest. Do not miss the chance to make this wonderful property your own.

NO forward chain!



Additional Information:

Situated in the quiet and modern development of Lacock Gardens, you are only a short distance away from Maidstone town centre where you will find a range of shops, restaurants and pubs. For commuters, you are only a short distance from Maidstone's mainline train stations where you have easy access to get into London or the coast and for those who drive you are not far from the M2 and M20 motorways.

Two double bedrooms

Popular location

Low maintenance rear garden

Allocated parking space

Gas central heating

Double glazed

Close to Maidstone town centre





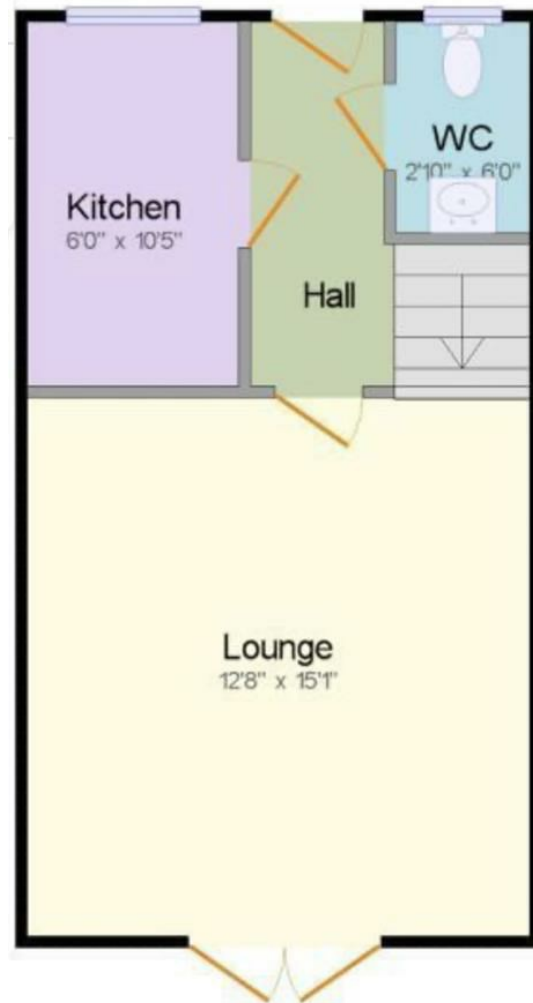

Ground Floor

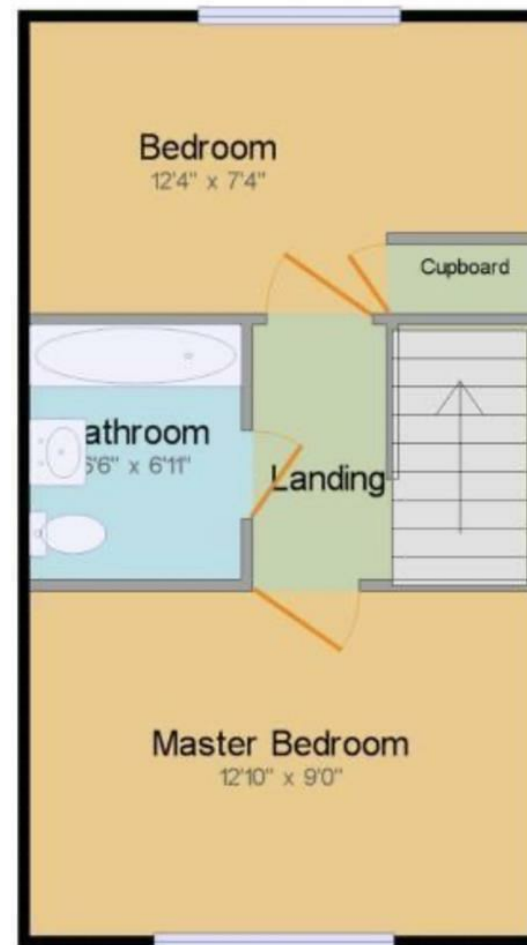

1st Floor

| Energy Efficiency Rating | | |
|---|---------|-------------------------|
| | Current | Potential |
| Very energy efficient - lower running costs | | |
| (92 plus) A | | |
| (81-91) B | | |
| (69-80) C | | |
| (55-68) D | | |
| (39-54) E | | |
| (21-38) F | | |
| (1-20) G | | |
| Not energy efficient - higher running costs | | |
| England & Wales | | EU Directive 2002/91/EC |

COLES

TOWN & COUNTRY

VALUERS • LETTINGS & ESTATE AGENTS

Location Map

